



www.genesislamp.com  
 info@genesislamp.com  
 Toll Free: 800-685-5267

**GENESIS LAMP**

375 North St. Clair St.  
 Painesville, OH 44077



## COMPLIANCES

L-862, L-862E  
 FAA AC 150/5345-46 (current edition)

ETL Certified



Meets all UFC 5-535-01 specifications.

Meets "Buy American" requirements.

ICAO ANNEX 14

## PRODUCT APPLICATION

The Hughey & Phillips L-862 Quartz elevated runway fixture is used on runway edge, threshold, displaced threshold and precision IFR runways. The L-862E Quartz fixture is used on runway threshold/end, displaced threshold and precision IFR runways.

## FEATURES

- Cast aluminum housing, painted aviation yellow, with powder-coated, electrostatically applied epoxy coating.
- Quick release stainless steel clamp allows for easy lamp changes.
- All materials are corrosion resistant.
- Tempered glass lens is heat and shatter resistant.
- Lens is keyed to ensure proper runway orientation.
- Easy to maintain, no special tools needed.
- Available in heights from 14-30 inches.
- Uses 6.6AMP Quartz bi-pin lamp for most applications.

# L-862 & L-862E Quartz

## High Intensity Runway Light

ELEVATED LIGHTS - 1.4

## ORDERING INFORMATION

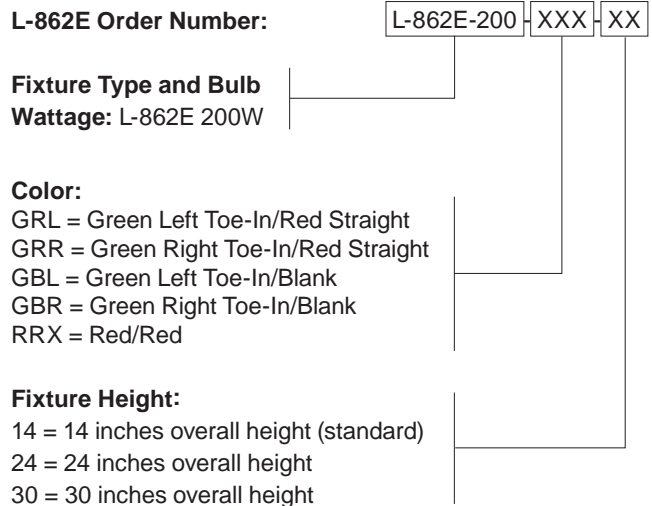
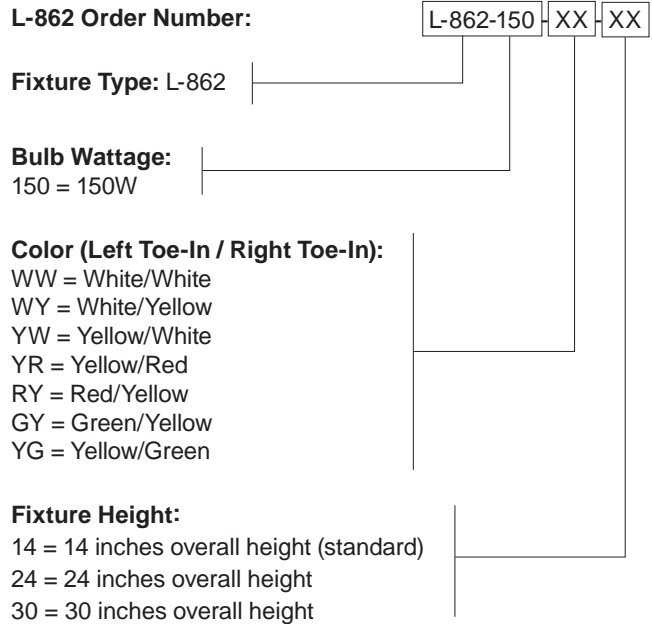

## RENEWAL PARTS

Description	Part Number
Outer Lens	
Clear <sup>1</sup>	A1-32-0003-001
Green/Red Left Toe-in <sup>2</sup>	A1-32-0005-001
Green/Red Right Toe-in <sup>2</sup>	A1-32-0005-002
Green/Blank Left Toe-in <sup>2</sup>	A1-32-0005-003
Green/Blank Right Toe-in <sup>2</sup>	A1-32-0005-004
Red/Red <sup>2</sup>	A1-32-0005-005
Blank/Red Left <sup>2</sup>	A1-32-0005-006
Blank/Red Right <sup>2</sup>	A1-32-0005-007
Clamp Band	A1-17-1027-002
Inner Lens Bracket Sub-Assembly (includes bracket & screws)	A1-17-1042-001
Inner Lens	
Inner Lens, White	A1-32-0002-001
Inner Lens, Red <sup>1</sup>	A1-32-0002-002
Inner Lens, Green <sup>1</sup>	A1-32-0002-003
Inner Lens, Yellow <sup>1</sup>	A1-32-0002-004
Bulb	
Quartz Halogen 150W Bulb <sup>1</sup>	A1-14-0077-002
Quartz Halogen 200W Bulb <sup>2</sup>	A1-14-0077-003
Disk & Socket Kit	K2-02-0001-001
O-Ring	AS568A-246
Housing	A1-18-2153-001
Strain Relief Bushing	D5975012-013
Screw	MS51957-80
EMT	
For 14-inch overall height	A1-17-1047-001
For 24-inch overall height	A1-17-1047-002
For 30-inch overall height	A1-17-1047-003
2-inch Frangible Coupling	A1-17-1134-004
L-823 Cable Assembly	
For 14-inch overall height	A2-17-0017-003
For 24-inch overall height	A2-17-0017-002
For 30-inch overall height	A2-17-0017-001

<sup>1</sup> For the L-862 fixture only

<sup>2</sup> For the L-862E fixture only

## TOE-IN CODING

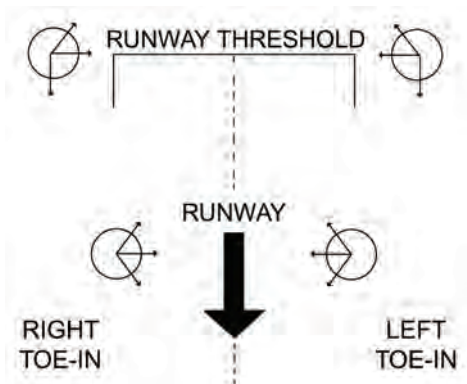

## EXPLODED VIEW

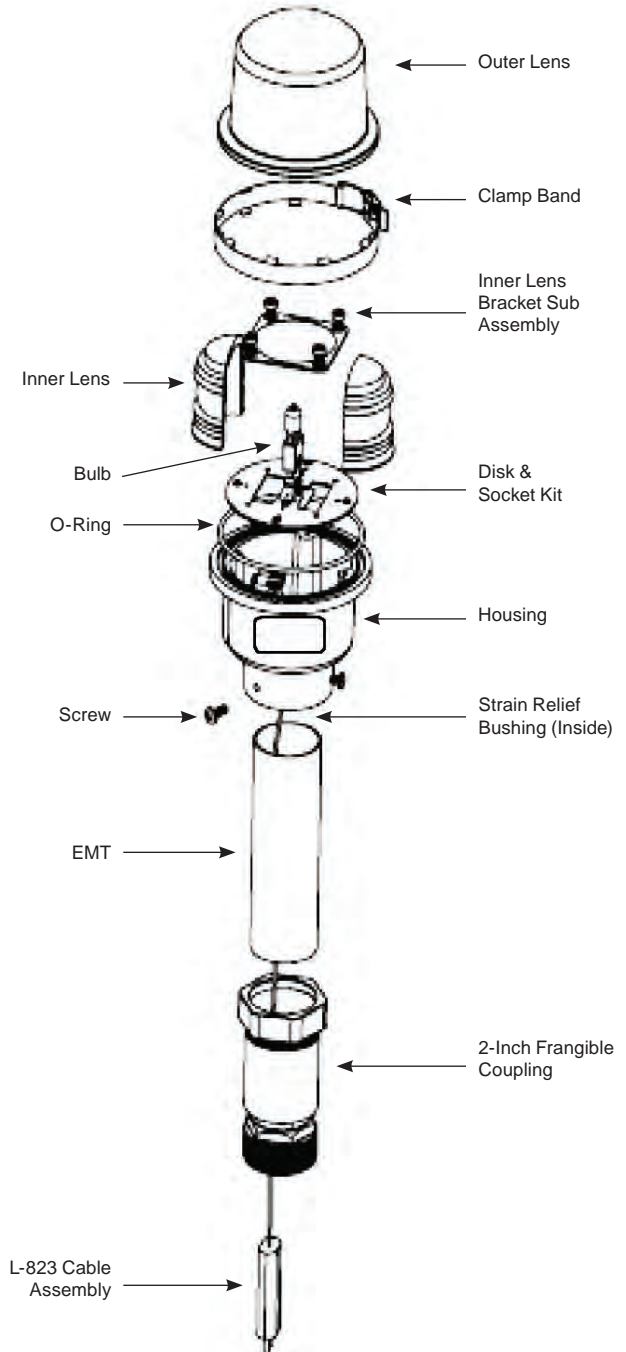

www.genesislamp.com  
 info@genesislamp.com  
 Toll Free: 800-685-5267

**GENESIS LAMP**

375 North St. Clair St.  
 Painesville, OH 44077

## SHIPPING INFORMATION

Dimensions of Carton (8 fixtures per carton w/EMTs)	Approx. Ship Weight
23" (l) x 24" (w) x 13" (h)	50 lb
58.42 cm (l) x 60.96 cm (w) x 33.02 cm (h)	23 kg

*Note: Fixtures are also available in one unit cartons.*

## ACCESSORIES

Description	Part Number	Approx. Wt.
L-867 Base Can	AC2124-2Q2-00301	52 lb/24 kg
Stake Mount 2" hub	AW2202	8 lb/3.6 kg
Isolation Trans. - 150W	11730	8.5 lb/3.9 kg
Isolation Trans. - 200W	11685	10.3 lb/4.7 kg
L-823 Primary Connector Kit (8 AWG, .320"/.430")	11174-01	.335 lb/.15 kg
L-823 Complete Kit (8 AWG, .320"/.430")	11805-01	.335 lb/.15 kg
Heat Shrink Tubing Kit	A2-20-0089-001	0.5 lb/0.23 kg
Base Plate	AP1932	8 lb/3.6 kg
Gasket	AK2052	0.4 lb/0.2 kg
L-862 Leveling Tool	T3-01-0043-001	

## INSTALLATION OPTIONS

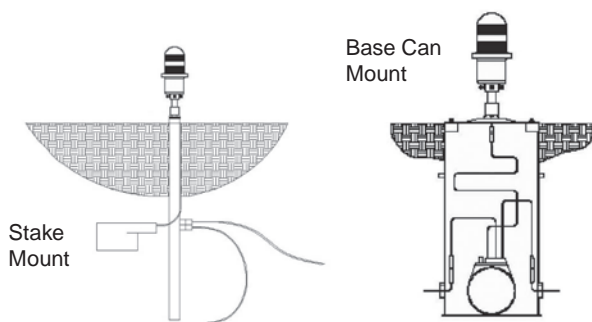

**GENESIS LAMP**

www.genesislamp.com  
info@genesislamp.com  
Toll Free: 800-685-5267

375 North St. Clair St.  
Painesville, OH 44077