



www.genesislamp.com
info@genesislamp.com
Toll Free: 800-685-5267

GENESIS LAMP

375 North St. Clair St.
Painesville, OH 44077

L-861T LED

Medium Intensity Taxiway Light



COMPLIANCES

L-861T(L)
FAA AC 150/5345-46 (current edition)
FAA Engineering Brief 67D



ETL Certified

Meets "Buy American" requirements.

ICAO: Annex 14, Vol. 1, para. 5.3.17

PRODUCT APPLICATION

The L-861T LED elevated taxiway light is an omnidirectional blue light that is used to delineate the edges of airport taxiways, holding bays, and aprons.

FEATURES

- Die cast aluminum body.
- Total Harmonic Distortion (THD) less than 1.1%.
- Less than 8.5VA at the highest step.
- Fixture MTBF is greater than 50,000 hours.
- Complies with intensity requirements for 3-step and 5-step series circuits.
- Standard fixture (without Arctic Kit) requires only a 10/15W isolation transformer.

EXTERNAL POWER REQUIREMENTS

Input

Constant Current Regulator (CCR)

Power

3 Step 4.8A, 5.5A, and 6.6A

or

5 Step 2.8A, 3.4A, 4.1, 5.2A and 6.6A

ELEVATED LIGHTS - 1.3A

ORDERING INFORMATION

L-861T LED Order Number: 861T - L - B - XX - X

Fixture Type:
L-861T LED Blue

Fixture Height:
14 = 14 inches overall height (standard)
24 = 24 inches overall height
30 = 30 inches overall height

0 = Without Arctic Kit
1 = With Arctic Kit

ACCESSORIES

Description	Part Number	Approx. Wt.
L-867 Base Can	AC2124-2Q2-00301	52 lb/23.6 kg
Stake Mount 1.5" hub	AW2205	12 lb/5.4 kg
L-823 Primary Connector Kit (8 AWG, .320"/.430")	11174-01	.335 lb/.15 kg
L-823 Complete Kit (8 AWG, .320"/.430")	11805-01	.335 lb/.15 kg
Heat Shrink Tubing Kit	A2-20-0089-001	.5 lb/.23 kg
Base Plate	AP1935	8 lb/3.6 kg
2" to 1.5" Baseplate Reducer	10701994	.5 lb/.23 kg
Gasket	10530287	.4 lb/.2 kg
L-861 Leveling Tool	T3-01-0063-001	

FUNCTIONAL CHARACTERISTICS

Condition	Range
Optics	1 surface-mounted, high-powered blue LED w/optically matched blue glass dome
Weight	4 lbs with 14" EMT and frangible coupling
Height	14-, 24-, and 30-inch options (overall height)
Total Harmonic Distortion	< 1.1%
Arctic Kit	Optional

Genesis Lamp Corp.

Phone: 440-354-0095 • Toll Free: 800-685-5267

www.genesislamp.com • info@genesislamp.com

375 North St. Clair St. Painesville, OH 44077

RENEWAL PARTS

Description	Part Number
Blue Globe	A1-32-0014-005
Light Engine Assembly	
No arctic kit	A3-06-3119-001
With arctic kit	A3-06-3119-002
Band Clamp	A1-17-1027-003
O-Ring, 3 3/4 ID, 0.013 Thick	AS568A-154
Fast Receptor Connector, 14-16 AWG, .187 x.032	A1-03-0260-001
Fixture Base	A1-17-1067-001
Strain Relief Bushing	D5975012-013
EMT	
For 14-inch overall height	A1-17-1034-03
For 24-inch overall height	A1-17-1034-08
For 30-inch overall height	A1-17-1034-21
1.5-inch Frangible Coupling	K1-02-0051-001
L-823 Cable Assembly	
For 14-inch overall height	A2-17-0017-003
For 24-inch overall height	A2-17-0017-002
For 30-inch overall height	A2-17-0017-001
Arctic Kit	A1-01-0163-001

EXPLODED VIEW

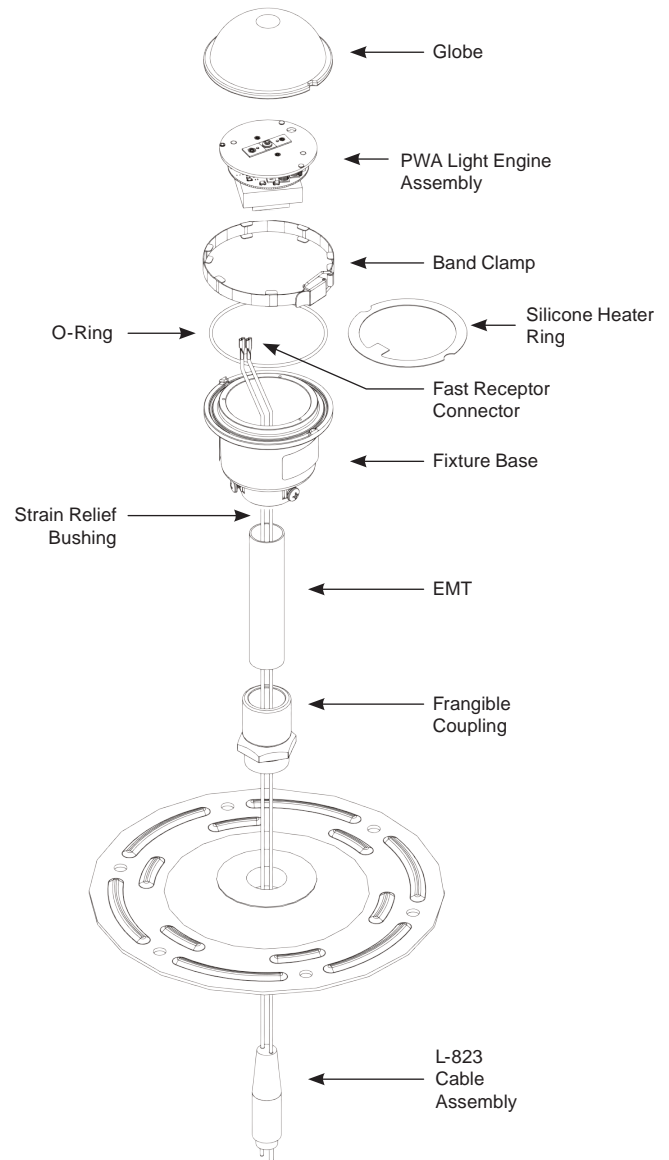

TRANSFORMER REQUIREMENTS

Type	Series Circuit	Fixture Load	Required Transformer	Part Number
No Arctic Kit	6.6A, 60Hz	8.19VA	L-830-16 (10/15W)	11717
	6.6A, 50Hz	8.19VA	L-831-16 (10/15W)	11732
	20A/6.6A, 60Hz	8.19VA	L-830-1 (30/45W)	11680
	20A/6.6A, 50Hz	8.19VA	L-831-1 (30/45W)	11710
With Arctic Kit	6.6A, 60Hz	20.2VA	L-830-17 (20/25W)	11729
	6.6A, 50Hz	20.2VA	L-831-17 (20/25W)	11733
	20A/6.6A, 60Hz	20.2VA	L-830-1 (30/45W)	11680
	20A/6.6A, 50Hz	20.2VA	L-831-1 (30/45W)	11710

Genesis Lamp Corp.

Phone: 440-354-0095 • Toll Free: 800-685-5267

www.genesislamp.com • info@genesislamp.com

375 North St. Clair St. Painesville, OH 44077