



GENESIS LAMP

www.genesislamp.com
info@genesislamp.com
Toll Free: 800-685-5267

375 North St. Clair St.
Painesville, OH 44077

L-861, L-861E & L-861SE LED

Medium Intensity Runway Light



COMPLIANCES

L-861(L), L-861E(L), L-861SE(L)
FAA AC 150/5345-46 (current edition)
FAA Engineering Brief 67D

ETL Certified



U.S. PATENT No. 9,206,961

Meets "Buy American" requirements.

ICAO: Annex 14, Vol. 1, para. 5.3.17

PRODUCT APPLICATION

The L-861 LED elevated light fixtures are used to delineate the edges of airport runways and displaced thresholds.

The L-861E LED elevated light fixtures are used to delineate airport runway thresholds/ends and displaced thresholds.

The L-861SE LED elevated light fixtures are used to delineate the edges of airport runway thresholds/ends.

FEATURES

- Die cast aluminum body.
- Total Harmonic Distortion (THD) less than 1.1%.
- Less than 25VA at the highest step for the standard runway fixture.
- Fixture MTBF is greater than 50,000 hours.
- Complies with intensity requirements for 3-step and 5-step circuit.
- No Arctic Kit is ever needed on the standard runway fixture.
- Requires only a 20/25W isolation transformer for the standard runway fixture and SE type, and a 10/15W for the E type.

ELEVATED LIGHTS - 1.2

ORDERING INFORMATION

L-861 LED Order Number:

861 | L | X(X) | XX

Runway Edge Light

Fixture Type:

861 = L-861

L = LED

Color:

W = Omnidirectional White

Y = Omnidirectional Yellow

WY = Bidirectional White/Yellow

WR = Bidirectional White/Red

YR = Bidirectional Yellow/Red

GY = Bidirectional Green/Yellow

WB = Unidirectional White*

YB = Unidirectional Yellow*

Fixture Height:

14 = 14 inches overall height (standard)

24 = 24 inches overall height

30 = 30 inches overall height

* Not FAA Certifiable

L-861E/SE LED Order Number:

861X(X) | L | XX | XX | X

**Runway Threshold/End
Displaced Threshold Light**

Fixture Type:

861E = L-861E

861SE = L-861SE

L = LED

Color:

GB = Unidirectional Green

RG = Bidirectional Red/Green

RR = Bidirectional Red/Red (E type only)

Fixture Height:

14 = 14 inches overall height (standard)

24 = 24 inches overall height

30 = 30 inches overall height

0 = Without Arctic Kit

1 = With Arctic Kit

Genesis Lamp Corp.

Phone: 440-354-0095 • Toll Free: 800-685-5267

www.genesislamp.com • info@genesislamp.com

375 North St. Clair St. Painesville, OH 44077

RENEWAL PARTS

Description

Part Number

Globe

White	A1-32-0014-001
Yellow	A1-32-0014-004
White/Red	A1-32-0014-006
Green/Yellow	A1-32-0014-007
White/Yellow	A1-32-0014-008
Yellow/Red	A1-32-0014-009
Green/Red (E and SE only)	A1-32-0014-010
Green/Blank (E and SE only)	A1-32-0014-011
Red/Red (861E only)	A1-32-0014-002

Light Engine Assembly Options

861, White	A3-06-3106-001
861, Green/Yellow	A3-06-3106-002
861E, Red/Green	A3-06-3114-001
861E, Red/Green, Arctic version	A3-06-3114-004
861E, Red/Red	A3-06-3114-002
861E, Red/Red, Arctic version	A3-06-3114-005
861E, Green/Blank	A3-06-3114-003
861E, Green/Blank, Arctic version	A3-06-3114-006
861SE, Red/Green	A3-06-3115-001
861SE, Red/Green, Arctic version	A3-06-3115-003
861SE, Green/Blank	A3-06-3115-002
861SE, Green/Blank, Arctic version	A3-06-3115-004

Band Clamp

A1-17-1027-003

O-Ring, 3 3/4 ID, 0.013 Thick

AS568A-154

Silicone Heater Ring (for Arctic version)

A1-01-0163-001

Fast Receptor Connector, 14-16 AWG, .187 x .032

A1-03-0260-001

Fixture Base

A1-17-1067-001

Strain Relief Bushing

D5975012-013

EMT

For 14-inch overall height

A1-17-1034-03

For 24-inch overall height

A1-17-1034-08

For 30-inch overall height

A1-17-1034-21

1.5-inch Frangible Coupling Kit

K1-02-0051-001

L-823 Cable Assembly

For 14-inch overall height

A2-17-0017-003

For 24-inch overall height

A2-17-0017-002

For 30-inch overall height

A2-17-0017-001

ACCESSORIES

Description

Part Number

Approx. Wt.

L-867 Base Can	AC2124-2Q2-00301	52 lb/23.6 kg
Stake Mount 1.5" hub	AW2205	12 lb/5.4 kg
L-823 Primary Connector Kit (8 AWG, .320"/.430")	11174-01	.335 lb/.15 kg
L-823 Complete Kit (8 AWG, .320"/.430")	11805-01	.335 lb/.15 kg
Heat Shrink Tubing Kit	A2-20-0089-001	.5 lb/.23 kg
Base Plate	AP1935	8 lb/3.6 kg
2" to 1.5" Baseplate Reducer	10701994	.5 lb/.23 kg
L-861 Leveling Tool	T3-01-0063-001	

EXPLODED VIEW

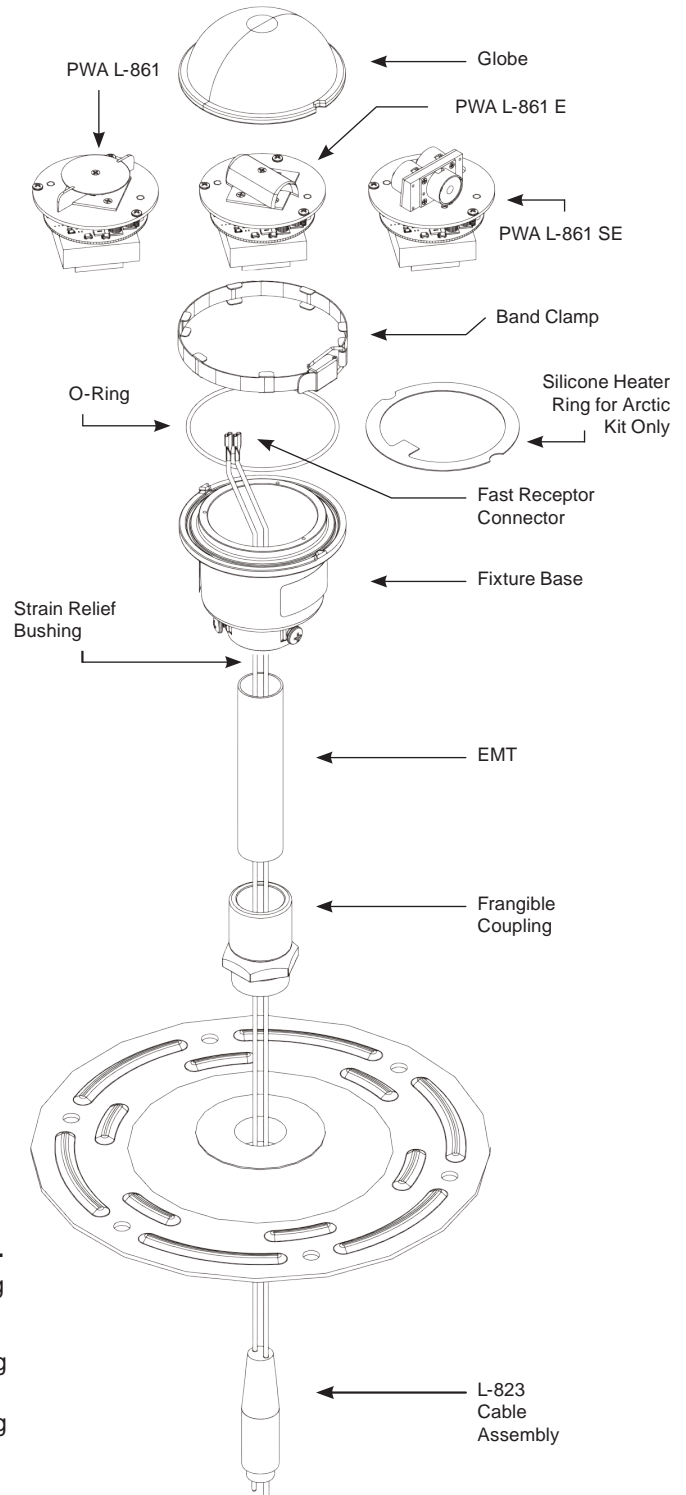

Genesis Lamp Corp.

Phone: 440-354-0095 • Toll Free: 800-685-5267

www.genesislamp.com • info@genesislamp.com

375 North St. Clair St. Painesville, OH 44077

L-861 TRANSFORMER REQUIREMENTS

L-861 Type	Series Circuit	Fixture Load	Required Transformer	Part Number
Uni &	6.6A, 60Hz	23.5VA	L-830-17 (20/25W)	11729
Bidirectional	6.6A, 50Hz	23.5VA	L-831-17 (20/25W)	11733
No Arctic Kit	20 A/6.6A, 60Hz	23.5VA	L-830-2 (30/45W)	11681
	20A/6.6A, 50Hz	23.5VA	L-831-2 (30/45W)	11723

L-861E TRANSFORMER REQUIREMENTS

L-861E Type	Series Circuit	Fixture Load	Required Transformer	Part Number
Unidirectional	6.6A, 60Hz	11.55VA	L-830-16 (10/15W)	11717
No Arctic Kit	6.6A, 50Hz	11.55VA	L-831-16 (10/15W)	11732
	20A/6.6A, 60Hz	11.55VA	L-830-2 (30/45W)	11681
	20A/6.6A, 50Hz	11.55VA	L-831-2 (30/45W)	11723
Bidirectional	6.6A, 60Hz	14.0VA	L-830-16 (10/15W)	11717
No Arctic Kit	6.6A, 50Hz	14.0VA	L-831-16 (10/15W)	11732
	20A/6.6A, 60Hz	14.0VA	L-830-2 (30/45W)	11681
	20A/6.6A, 50Hz	14.0VA	L-831-2 (30/45W)	11723
Unidirectional	6.6A, 60Hz	26.1VA	L-830-1 (30/45W)	11680
With Arctic Kit	6.6A, 50Hz	26.1VA	L-831-1 (30/45W)	11710
	20A/6.6A, 60Hz	26.1VA	L-830-2 (30/45W)	11681
	20A/6.6A, 50Hz	26.1VA	L-831-2 (30/45W)	11723
Bidirectional	6.6 A, 60Hz	26.4VA	L-830-1 (30/45W)	11680
With Arctic Kit	6.6 A, 50Hz	26.4VA	L-831-1 (30/45W)	11710
	20 A/6.6A, 60Hz	26.4VA	L-830-2 (30/45W)	11681
	20 A/6.6A, 50Hz	26.4VA	L-831-2 (30/45W)	11723

L-861SE TRANSFORMER REQUIREMENTS

L-861SE Type	Series Circuit	Fixture Load	Required Transformer	Part Number
Unidirectional	6.6A, 60Hz	16.3VA	L-830-17 (20/25W)	11729
No Arctic Kit	6.6A, 50Hz	16.3VA	L-831-17 (20/25W)	11733
	20A/6.6A, 60Hz	16.3VA	L-830-2 (30/45W)	11681
	20A/6.6A, 50Hz	16.3VA	L-831-2 (30/45W)	11723
Bidirectional	6.6A, 60Hz	19.12VA	L-830-17 (20/25W)	11729
No Arctic Kit	6.6A, 50Hz	19.12VA	L-831-17 (20/25W)	11733
	20A/6.6A, 60Hz	19.12VA	L-830-2 (30/45W)	11681
	20A/6.6A, 50Hz	19.12VA	L-831-2 (30/45W)	11723
Unidirectional	6.6A, 60Hz	26.9VA	L-830-1 (30/45W)	11680
With Arctic Kit	6.6A, 50Hz	26.9VA	L-831-1 (30/45W)	11710
	20A/6.6A, 60Hz	26.9VA	L-830-2 (30/45W)	11681
	20A/6.6A, 50Hz	26.9VA	L-831-2 (30/45W)	11723
Bidirectional	6.6A, 60Hz	29.3VA	L-830-1 (30/45W)	11680
With Arctic Kit	6.6A, 50Hz	29.3VA	L-831-1 (30/45W)	11710
	20A/6.6A, 60Hz	29.3VA	L-830-2 (30/45W)	11681
	20A/6.6A, 50Hz	29.3VA	L-831-2 (30/45W)	11723

Genesis Lamp Corp.

Phone: 440-354-0095 • Toll Free: 800-685-5267

www.genesislamp.com • info@genesislamp.com

375 North St. Clair St. Painesville, OH 44077